



How To Use This Manual

The next few pages describe how this manual is organized. They also explain what kind of information the manual contains, what the information means, and how to use it to troubleshoot electrical problems.

Circuit schematics break the entire electrical system into individual systems, like the Back-up Lights on the next page. Only electrical components that work together are shown together, so you won't be distracted by unrelated wires.

Explanations of the abbreviations and symbols used in the schematics begin on page [7](#). You'll need to know what they mean before you can use a schematic effectively.

How To Use This Manual

Circuit Schematics

Each schematic represents one circuit. A circuit's wires and components are arranged to show current flow, from power at the top of the page, to ground at the bottom.

Shared Circuits

Other circuits may share power or ground terminals or wiring with the circuit shown. A wire that connects one circuit to another, for example, is cut short and has an arrowhead at the end of it pointing in the direction of current flow. Next to the arrowhead is the name of the circuit or component which shares that wiring. To quickly check shared wiring, check the operation of a component it serves. If that component works, you know the shared wiring is OK.

Connectors

All in-line and junction connectors are numbered (C725, C416, etc.). Component connectors are not numbered but are identified either by the name of the component if the component only has one connector, or by a capital letter (A, B, C, etc.) if the component has *more than one* connector.

Below most connector numbers and component names are PHOTO and VIEW numbers. The PHOTO number refers to a photo in the back of the book that shows the connector's location on the car. The VIEW number refers to an illustration in the back of the book that shows the connector terminals, wire colors, connector cavity numbers, and other details.

The connector cavity numbering sequence begins at the top left corner of the connector as seen from either of the viewpoints shown on page 8. Except for the DLC (data link connector), disregard any numbers molded into the connector housing.

Wires

Wires are identified by the abbreviated names of their colors; the second color is the color of the stripe. Wires are also identified by their location in a connector. The number "2" next to the male and female wire terminals at C554, for example, means those terminals join in cavity 2 of connector C554.

Symbols

A complete description of schematic symbols begins on page 7.

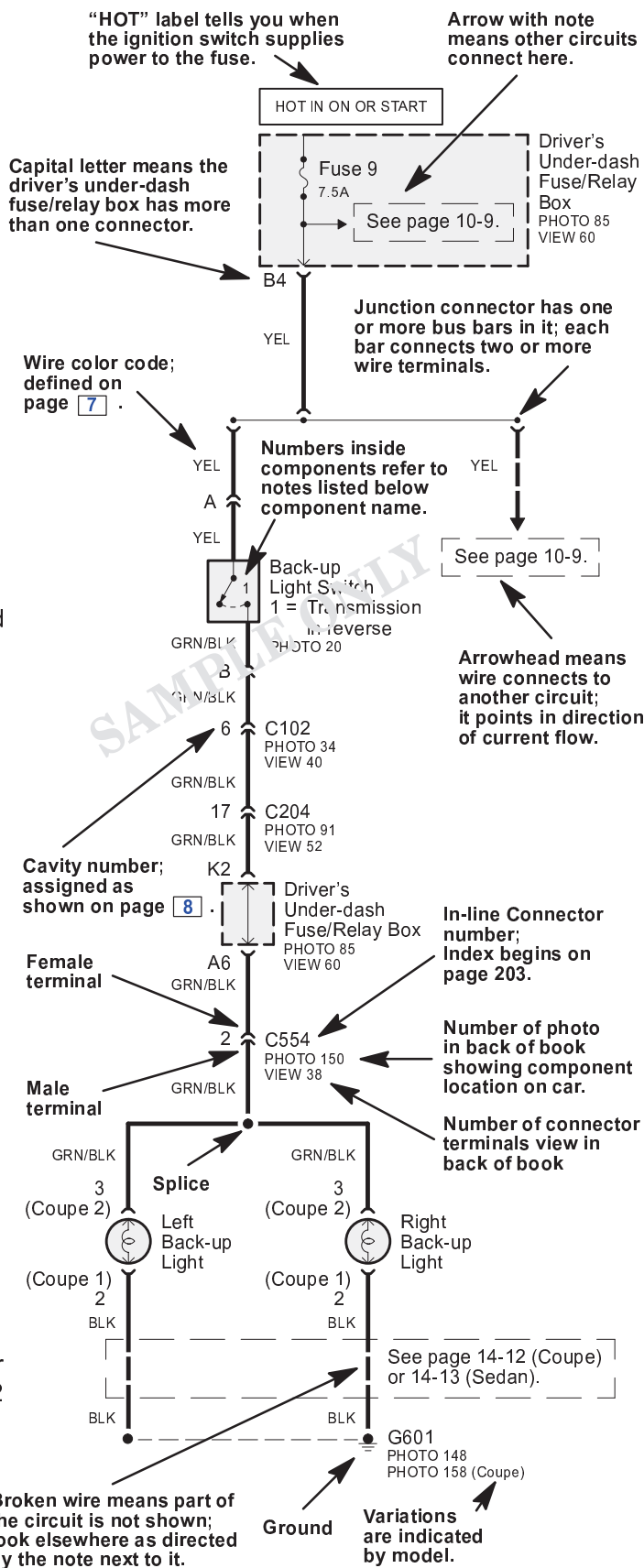



How To Use This Manual

Power Distribution Schematics

Power Distribution schematics show how power is supplied from the positive battery terminal to various circuits in the vehicle. Refer to the Power Distribution section to get a more detailed understanding of how power is supplied to the circuit you're working on. Individual circuit schematics begin with a fuse. So if Power Distribution shows that an inoperative circuit and another circuit share a fuse, check a component in the other circuit. If it works, you know the fuse is good and power is available to the inoperative circuit.

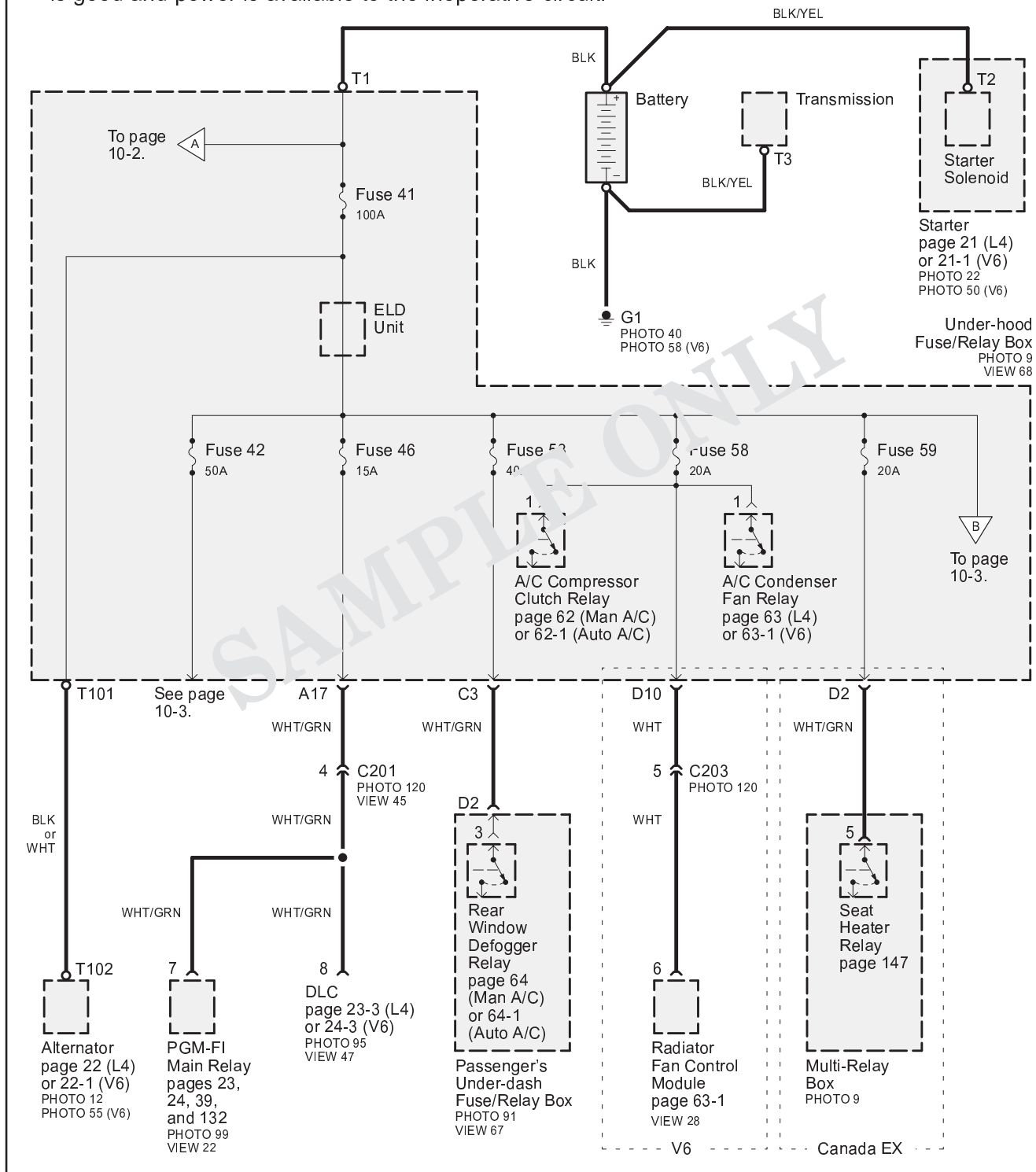

How To Use This Manual

Ground Distribution Schematics

This sample Ground Distribution schematic shows all of the components that share the same ground point.

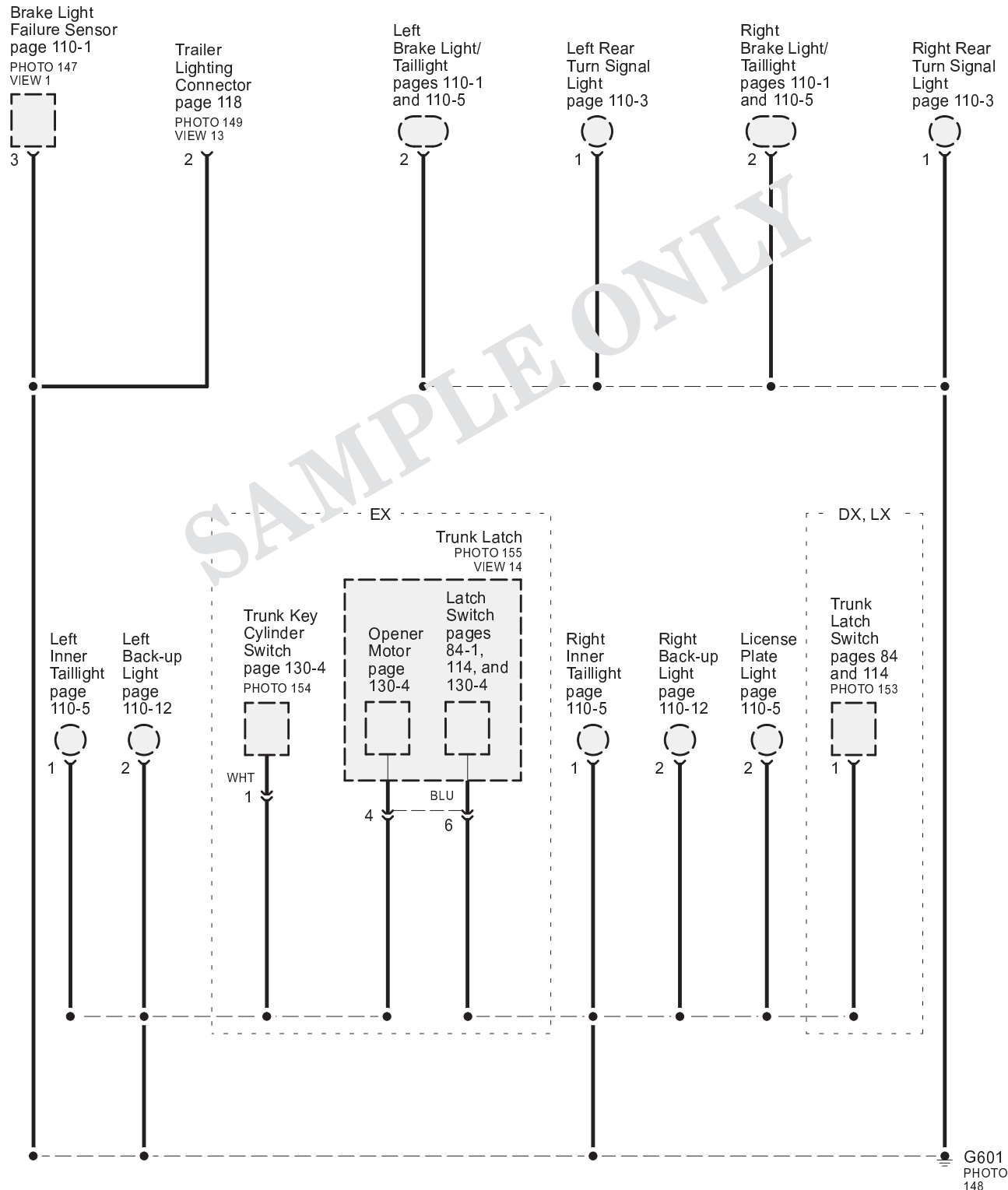



How To Use This Manual

Connector Locations

To see where a component or connector is located on the car, look up its photo number in the Component Location section that begins on page 201. The photo will also tell you the color of the connector, and how many cavities it has.

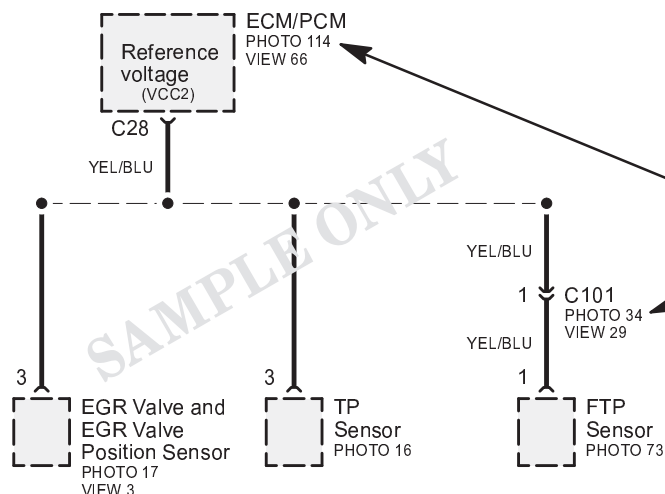

To see where connectors and parts are located, look up their photos in the Component Location section that begins on page 201.

If there is no photo number below or beside a component name or a connector, ground, or terminal number, look up that name or number in the appropriate Connector-to-Harness Index that begins on page 203. The chart lists how many cavities a connector has, where it's located, and what it connects to. The related illustration shows the connector's location on the harness, and the harness routing.

Driver's Power Seat Wire Harness

Ref	Connector or Terminal	Cavities/Color	Location	Connects to	Notes
1	Power seat rear up-down motor	2-GRY	Under driver's seat		EX
2	Power seat front up-down motor	2-GRY	Under driver's seat		EX
3	Driver's seat belt switch	2-GRY	Under driver's seat		EX
4	Not used	3	Under driver's seat		Heate seats
5	Power seat adjustment switch	6-GRY	Left side of driver's seat		
EX	connector B				
6	C552	10-GRY	Under driver's seat	Left side wire harness (see page 203-20)	
7	Power seat adjustment switch	6-GRY	Left side of driver's seat		
EX	connector A				
8	Power seat recline motor	2-GRY	Under driver's seat		EX
9	Power seat slide motor	2-GRY	Under driver's seat		EX

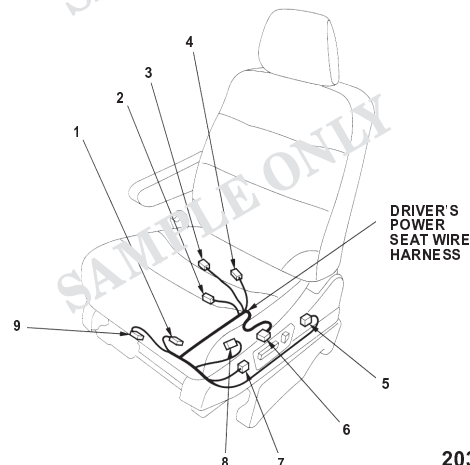

How To Use This Manual

Connector Terminal Views

To see the configuration of a connector's cavities, look up its view number in the Connector View section that begins on page 202. Each view includes the color of the connector, where it is located, and what it connects to.

Use the Connector Views to help locate the proper cavity when you need to test a connector. It can be especially helpful if the connector has more than one wire of the same color. A dash symbol (—) indicates that the cavity is empty.

Connector views can also be used to help diagnose multiple symptoms in separate circuits which could be caused by a single problem in a connector shared by those circuits. Here's how:

- 1 Pick one of the multiple symptoms and look up the schematic for that circuit.
- 2 Make a list of all the in-line and fuse box connectors in that schematic (include page numbers).
- 3 Then, in the Connector View section, look up each connector on your list to see if circuits related to the other symptoms run through one of them. If they do, inspect that connector for the problem.

Example: The blower, rear window defogger, and the windshield wiper don't work. List all in-line and fuse box connectors in the blower controls circuit and then check the Connector View section (sample below). You find that C324 is common to the rear window defogger circuit and wiper/washer circuit, so you inspect C324 and find the problem, damaged terminals.

Connector Terminal Views

21. C324

- Brown
- Behind left kick panel
- Connects left engine compartment wire harness to main wire harness



- | | |
|-------------------------------------|--------------------------|
| 1 WHT (Blower controls) | 4 BLU/YEL (Wiper/washer) |
| 2 YEL/BLU
(Rear window defogger) | 5 BLU (Wiper/washer) |
| 3 BLK/WHT (Starting) | 6 BLK/YEL (Ignition) |
| | 7 WHT/BLU (ABS) |